

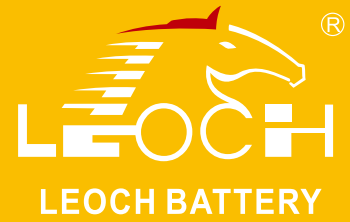

# LP Series-General Purpose LP12-7.2(12V7.0Ah)



## Specifications

Rated Voltage	12V	
Nominal Capacity	7.0Ah	(C <sub>20</sub> , 1.75V/cell)
Dimension	Length	151±2mm (5.94 inches)
	Width	65±1mm (2.56 inches)
	Container Height	93.5±1mm (3.68 inches)
	Total Height	99.5±1mm (3.92 inches)
Approx Weight	2.08kg (4.59 lbs)	
Terminal	T1/T2	
Container Material	ABS	
Rated Capacity (25°C)	7.00 Ah	C20(0.350A, 1.75V/cell)
	6.62 Ah	C10(0.662A, 1.75V/cell)
	5.85 Ah	C5(1.17A, 1.75V/cell)
	5.04 Ah	C3(1.68A, 1.75V/cell)
	4.21 Ah	C1(4.21A, 1.60V/cell)
Max. Discharge Current	105A (5s)	
Internal Resistance (25°C)	Approx 29mΩ	
Operating Temp. Range	Discharge	-20 ~ 50°C (-4 ~ 131°F)
	Charge	-20 ~ 40°C (-4 ~ 104°F)
	Storage	-15 ~ 50°C (5 ~ 122°F)
Nominal Operating Temp. Range	25±3°C (77±5°F)	
Cycle Use	Initial Charging Current less than 2.1A. Voltage 14.4V~15.0V at 25°C(77°F)Temp. Coefficient -30mV/°C	
	Standby Use	
Effect of temp. to Capacity	Initial Charging Current less than 2.1A. Voltage 13.5V~13.8V at 25°C(77°F)Temp. Coefficient -20mV/°C	
	40°C (104°F)	103%
	25°C (77°F)	100%
Self Discharge	0°C (32°F)	86%
	LP series batteries may be stored for up to 6 months at 25°C(77°F) and then a freshening charge is required. For higher temperatures the time interval will be shorter.	



## Layout

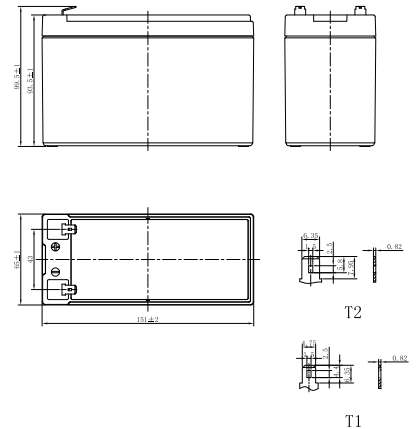

## Constant Current Discharge (Amperes) at 25 °C (77°F)

F.V/Time	5min	10min	15min	20min	30min	45min	1h	1.5h	2h	3h	4h	5h	6h	8h	10h	20h
1.85V/cell	20.2	13.6	10.6	8.58	6.32	4.63	3.81	2.81	2.22	1.63	1.32	1.14	0.990	0.791	0.647	0.342
1.80V/cell	21.7	14.4	11.1	8.92	6.51	4.76	3.90	2.87	2.27	1.66	1.34	1.16	1.01	0.802	0.656	0.346
1.75V/cell	22.9	15.0	11.4	9.17	6.68	4.86	3.98	2.92	2.31	1.68	1.36	1.17	1.02	0.811	0.662	0.350
1.70V/cell	24.0	15.6	11.8	9.44	6.85	4.97	4.05	2.97	2.34	1.71	1.37	1.19	1.03	0.820	0.669	0.353
1.67V/cell	24.8	16.0	12.1	9.63	6.97	5.05	4.11	3.01	2.37	1.72	1.39	1.20	1.04	0.826	0.674	0.356
1.60V/cell	26.3	16.7	12.5	9.92	7.16	5.17	4.21	3.07	2.42	1.76	1.41	1.22	1.05	0.838	0.682	0.359

## Constant Power Discharge (Watts/cell) at 25 °C (77°F)

F.V/Time	5min	10min	15min	20min	30min	45min	1h	1.5h	2h	3h	4h	5h	6h	8h	10h	20h
1.85V/cell	38.2	25.8	20.2	16.5	12.2	8.99	7.40	5.49	4.36	3.20	2.60	2.25	1.96	1.57	1.29	0.684
1.80V/cell	40.7	27.2	21.1	17.1	12.5	9.20	7.56	5.58	4.43	3.25	2.63	2.28	1.99	1.59	1.30	0.692
1.75V/cell	42.4	28.1	21.6	17.5	12.8	9.36	7.69	5.67	4.49	3.29	2.66	2.30	2.01	1.61	1.31	0.700
1.70V/cell	44.0	29.0	22.2	17.9	13.1	9.53	7.80	5.75	4.55	3.34	2.70	2.33	2.03	1.62	1.33	0.706
1.67V/cell	45.2	29.6	22.7	18.2	13.3	9.66	7.91	5.81	4.59	3.36	2.72	2.35	2.04	1.63	1.34	0.711
1.60V/cell	47.0	30.5	23.3	18.7	13.6	9.84	8.05	5.91	4.67	3.42	2.76	2.38	2.07	1.65	1.35	0.719



# LP Series-General Purpose LP12-7.2(12V7.0Ah)

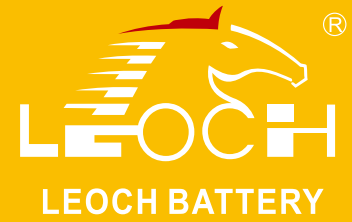

## Applications

- All purpose
- Uninterruptable Power Supply (UPS)
- Electric Power System (EPS)
- Emergency backup power supply
- Alarm and security system
- Communication power supply
- DC power supply
- Auto control system

## General Features

- 5 years design life(25°C)
- Special exhaust structure and sealing technology, safe and reliable, flexible installation, convenient maintenance
- PbCaSn alloy for plate grids: less gassing, less self-discharging
- High quality AGM separator: extend cycle life and prevent micro short circuit
- High purity raw material: ensure low self discharge rate

## Standards

- Compliance with IEC 60896 standards, EU Battery Directive
- UL, CE Certified
- Manufactured in Leoch@IATF16949, ISO45001,ISO 9001 and ISO 14001 certified production facilities

## Discharge Characteristics

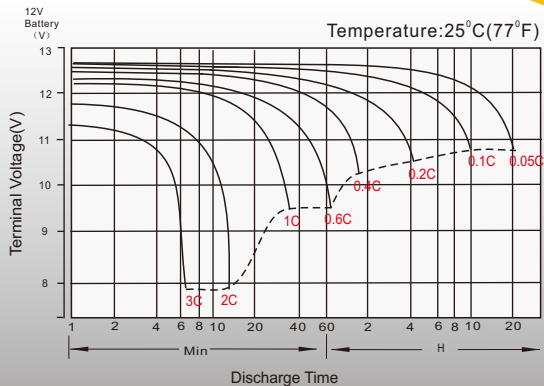

## Float Charging Characteristics

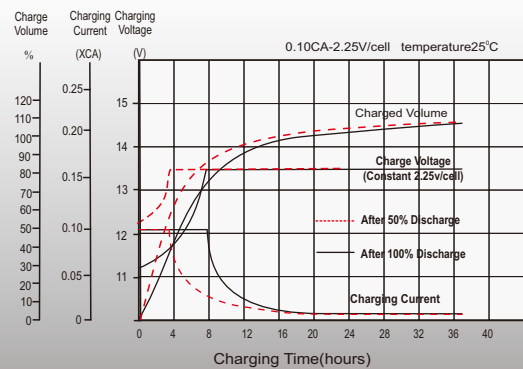

## Temperature Effects in Relation to Battery Capacity

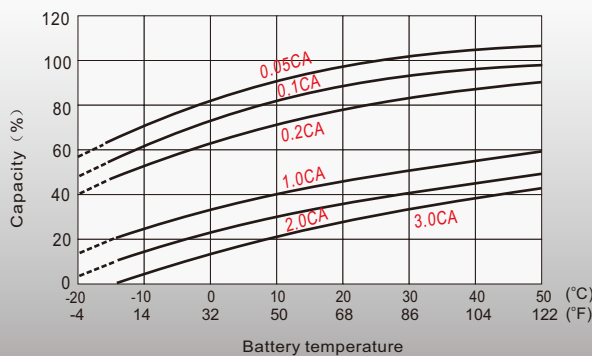

## Float Service Life

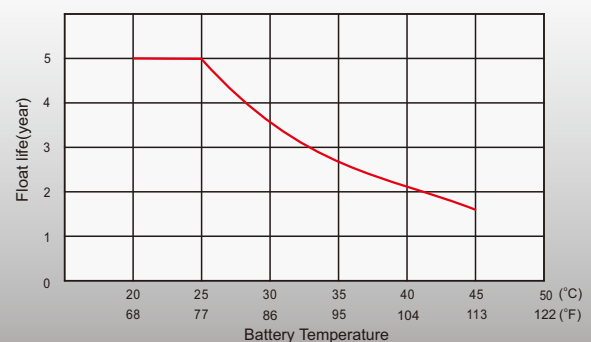

## Sales Offices Worldwide

### China Sales Office

5th Floor, Xinbaohui Bldg., Nanhai Blvd.,  
Nanshan, Shenzhen, China. 518052  
Tel: +86-755-86036060 (100 lines)  
Tel: 949-588-5853  
Fax: +86-755-26067269  
E-mail: export@leoch.com

### HongKong Sales Office

Workshop C, 33/F, TML Tower, No. 3 Hoi Shing Road,  
Tsuen Wan, New Territories, Hong Kong  
Tel: +852 35786666  
Tel: +44(0) 1452 729428 / 1452 729696  
Fax: +44 1452 690125  
E-mail: sales.hk@leoch.com

### Singapore Sales Office

No. 1 Tech Park Crescent,  
Singapore 638131  
Tel: +65 68636078  
Tel: +30 210 5760318 (2 lines)  
Fax: +65 6863 6079  
E-mail: sales.sg@Leoch.com

### Australia Sales Office

2 /29 Tarlington Place, Smithfield. NSW 2164  
Australia  
Tel: 02 9756 0950  
E-mail: sales.au@leoch.com

### North America Sales Office

19751 Descartes  
Foothill Ranch, CA 92610, USA  
Tel: 949-588-5853  
Tel: 949-588-5966  
E-mail: sales@leoch.us  
Http:// www.leoch.us

### UK Sales Office

9B Wheatstone Court. Waterwells, Business Park,  
Gloucester, GL2-2AQ, UK United Kingdom  
Tel: +44(0) 1452 729428 / 1452 729696  
Tel: +44 1452 690125  
E-mail: Sales.Europe@leoch.com  
Http:// www.leoch.eu

### EMEA Sales Office

1 Deligiorgi St., 121 31 Athens,  
Greece  
Tel: +30 210 5760318 (2 lines)  
Tel: support\_EMEA@leoch.com  
Http:// www.leoch.eu

### India Sales Office

Shed no.A-53(b), 2nd Stage of Peenya Industrial Area,  
Bangalore North Taluk, Bangalore-560058, India  
Tel: +91-80-23440018/23440019  
Tel: +91-80-23440017  
E-mail: indiasales@leoch.com



[Http://www.leoch.com](http://www.leoch.com)

© 2022 LEOCH. All rights reserved.

Trademarks and logos are the property of LEOCH and its affiliates unless otherwise noted.  
Subject to revisions without prior notice.

Publication No.: LB-LP12-7.2-PD-DZ-V1.0-202206