



# LP Series-General Purpose LP12-26(12V26Ah)



## Specifications

Rated Voltage	12V	
Nominal Capacity	26.0Ah	(C <sub>20</sub> , 1.75V/cell)
Dimension	Length	166±2mm (6.64 inches)
	Width	175±2mm (6.89 inches)
	Container Height	125±2mm (4.92 inches)
	Total Height	125±2mm (4.92 inches)
Approx Weight	7.80kg (17.2 lbs)	
Terminal	T3	
Container Material	ABS	
Rated Capacity (25°C)	26.0 Ah	C20(1.30A, 1.75V/cell)
	24.0 Ah	C10(2.40A, 1.80V/cell)
	21.7 Ah	C5(4.33A, 1.75V/cell)
	18.9 Ah	C3(6.31A, 1.75V/cell)
	15.7 Ah	C1(15.7A, 1.60V/cell)
Max. Discharge Current	390A (5s)	
Internal Resistance (25°C)	Approx 14mΩ	
Operating Temp. Range	Discharge	-15 ~ 50°C (5 ~ 122°F)
	Charge	-20 ~ 40°C (-4 ~ 104°F)
	Storage	-15 ~ 40°C (5 ~ 104°F)
Nominal Operating Temp. Range	25±3°C (77±5°F)	
Cycle Use	Initial Charging Current less than 7.8A. Voltage 14.4V~15.0V at 25°C(77°F)Temp. Coefficient -30mV/°C	
	Initial Charging Current less than 7.8A. Voltage 13.5V~13.8V at 25°C(77°F)Temp. Coefficient -20mV/°C	
Standby Use	Initial Charging Current less than 7.8A. Voltage 13.5V~13.8V at 25°C(77°F)Temp. Coefficient -20mV/°C	
Effect of temp. to Capacity	40°C (104°F)	103%
	25°C (77°F)	100%
	0°C (32°F)	86%
Self Discharge	LP series batteries may be stored for up to 6 months at 25°C(77°F) and then a freshening charge is required. For higher temperatures the time interval will be shorter.	



## Layout

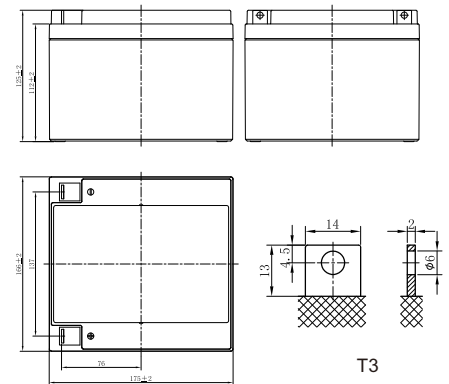

T3

## Constant Current Discharge (Amperes) at 25 °C (77°F)

F.V/Time	5min	10min	15min	20min	30min	45min	1h	1.5h	2h	3h	4h	5h	6h	8h	10h	20h
1.85V/cell	49.5	34.5	28.5	24.6	19.8	15.3	12.5	9.31	7.61	5.79	4.77	4.05	3.51	2.79	2.32	1.29
1.80V/cell	60.9	41.2	33.0	28.0	21.9	16.6	13.4	9.92	8.08	6.10	5.02	4.21	3.66	2.89	2.40	1.30
1.75V/cell	72.1	46.5	36.4	30.4	23.5	17.7	14.1	10.4	8.43	6.31	5.17	4.33	3.75	2.97	2.45	1.31
1.70V/cell	81.9	51.3	39.5	32.6	24.6	18.3	14.7	10.8	8.78	6.52	5.30	4.43	3.84	3.01	2.49	1.34
1.67V/cell	90.2	55.1	41.7	34.3	25.7	19.0	15.3	11.2	9.03	6.67	5.40	4.54	3.91	3.05	2.52	1.35
1.60V/cell	94.6	57.5	43.4	35.3	26.3	19.4	15.7	11.4	9.32	6.84	5.54	4.63	3.99	3.12	2.57	1.37

## Constant Power Discharge (Watts/cell) at 25 °C (77°F)

F.V/Time	5min	10min	15min	20min	30min	45min	1h	1.5h	2h	3h	4h	5h	6h	8h	10h	20h
1.85V/cell	93.3	65.8	54.8	47.8	38.7	30.0	24.5	18.3	15.1	11.5	9.50	8.09	7.03	5.59	4.67	2.60
1.80V/cell	113.5	77.7	62.9	53.7	42.4	32.3	26.3	19.5	16.0	12.0	9.92	8.38	7.29	5.77	4.81	2.61
1.75V/cell	132.8	86.9	68.7	58.0	45.0	34.2	27.5	20.3	16.6	12.4	10.2	8.56	7.43	5.89	4.86	2.63
1.70V/cell	149.1	94.9	73.8	61.8	47.1	35.3	28.5	21.0	17.1	12.7	10.4	8.73	7.56	5.94	4.93	2.65
1.67V/cell	162.0	100.7	77.1	64.2	48.6	36.5	29.6	21.8	17.5	13.0	10.5	8.89	7.68	6.01	4.97	2.68
1.60V/cell	167.5	103.6	79.4	65.5	49.4	36.9	30.0	22.0	18.0	13.2	10.7	9.00	7.79	6.11	5.02	2.69



# LP Series-General Purpose LP12-26(12V26Ah)



## Applications

- All purpose
- Uninterruptable Power Supply (UPS)
- Electric Power System (EPS)
- Emergency backup power supply
- Alarm and security system
- Communication power supply
- DC power supply
- Auto control system

## General Features

- 5 years design life(25°C)
- Special exhaust structure and sealing technology, safe and reliable, flexible installation, convenient maintenance
- PbCaSn alloy for plate grids: less gassing, less self-discharging
- High quality AGM separator: extend cycle life and prevent micro short circuit
- High purity raw material: ensure low self discharge rate

## Standards

- Compliance with IEC 60896 standards, EU Battery Directive
- UL, CE Certified
- Manufactured in Leoch®IATF16949, ISO45001,ISO 9001 and ISO 14001 certified production facilities

## Discharge Characteristics

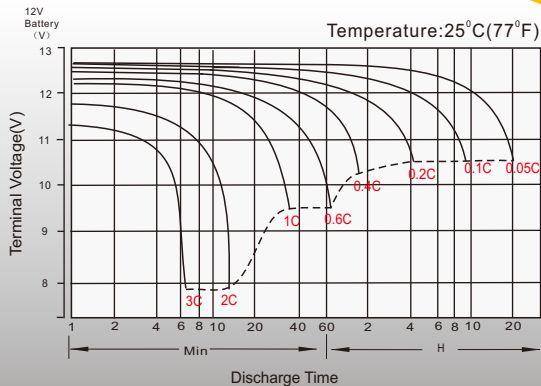

## Float Charging Characteristics

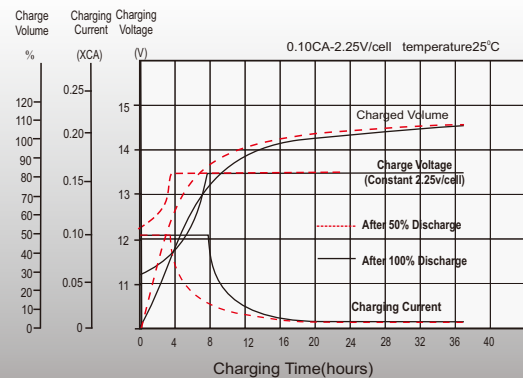

## Temperature Effects in Relation to Battery Capacity

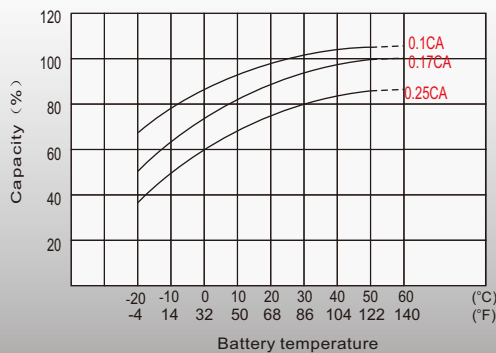

## Float Service Life

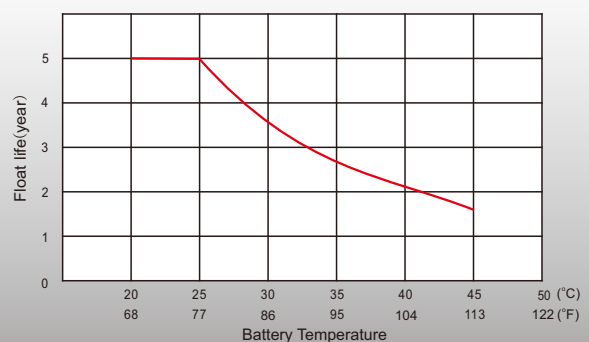

## Sales Offices Worldwide

### China Sales Office

5th Floor, Xinbaohui Bldg., Nanhai Blvd.,  
Nanshan, Shenzhen, China. 518052  
Tel: +86-755-86036060 (100 lines)  
Fax: +86-755-26067269  
E-mail: export@leoch.com

### HongKong Sales Office

Workshop C, 33/F, TML Tower, No. 3 Hoi Shing Road,  
Tsuen Wan, New Territories, Hong Kong  
Tel: +852 35786666  
Fax: +44 1452 690125  
E-mail: sales.hk@leoch.com

### Singapore Sales Office

No. 1 Tech Park Crescent,  
Singapore 638131  
Tel: +65 68636078  
Fax: +65 6863 6079  
Email: sales.sg@Leoch.com

### Australia Sales Office

2 /29 Tarlington Place, Smithfield. NSW 2164  
Australia  
Tel: 02 9756 0950  
E-mail: sales.au@leoch.com

### North America Sales Office

19751 Descartes  
Foothill Ranch, CA 92610, USA  
Tel: 949-588-5853  
Fax: 949-588-5966  
E-mail: sales@leoch.us  
Http:// www.leoch.us

### UK Sales Office

9B Wheatstone Court. Waterwells, Business Park,  
Gloucester, GL2-2AQ, UK United Kingdom  
Tel: +44(0) 1452 729428 / 1452 729696  
Fax: +44 1452 690125  
E-mail: Sales.Europe@leoch.com  
Http:// www.leoch.eu

### EMEA Sales Office

1 Deligiorgi St., 121 31 Athens,  
Greece  
Tel: +30 210 5760318 (2 lines)  
E-mail: support\_EMEA@leoch.com  
Http:// www.leoch.eu

### India Sales Office

Shed no.A-53(b), 2nd Stage of Peenya Industrial Area,  
Bangalore North Taluk, Bangalore-560058, India  
Tel: +91-80-23440018/23440019  
Fax: +91-80-23440017  
E-mail: indiasales@leoch.com



[Http://www.leoch.com](http://www.leoch.com)

© 2022 LEOCH. All rights reserved.

Trademarks and logos are the property of LEOCH and its affiliates unless otherwise noted.  
Subject to revisions without prior notice.

Publication No.: LB-LP12-26-PD-DZ-V1.0-202206